



# Maroubra Bay

## Public School

respect | responsibility | care

## Newsletter T1 W1

Thursday January 31, 2019



### Classes are in...

It's been wonderful to see all our students returning this year. It has been even more exciting to see a number of new families join our Maroubra Bay family in 2019. A warm welcome to all our students this year.

The teachers have all commented how settled and focused the students have been in their new classes. There is certainly a lot of happiness and friendly games happening in the playground as students catch up with each other.

On Monday we see our 63 Kindergarten students all start their formal education journey. It may be busier in the surrounding streets so families may like to make alternative arrangements to help alleviate predicted congestion.

### Breakfast Club Initiative

Our school, in partnership with St. Vincent de Paul and our Canteen, will be providing a free breakfast club for students each morning. The service is designed for students who have difficulty in having breakfast in the morning, either through organization or financial reasons. The breakfast club will be in the Canteen with Sallie-Ann. Please see the next page for more information.



### Parent Information Evening

On Tuesday February 12 we will be holding our annual Parent Information Evening which is a time for parents to come up and meet the teachers and hear about the great things planned for 2019. This will be particularly useful this year as we have new classroom settings and new staff to introduce. I hope many parents can attend.

There will be a note sent home early next week with all the times and organisation.

### Swimming Carnival

The swimming carnival for students in Years 3 to 6 will be held on Thursday 14 February at Des Renford. A note will be sent home to all students involved today. We hope that all students will attend. Strong swimmers in Year 2 who turn 8 this year are also invited to compete. Parents and community members are also welcome to attend and support their child.

### Attendance

Education for your child is important and regular attendance at school is essential for them to achieve their educational best and increase their career and life options.

NSW public schools work in partnership with parents to encourage and support regular attendance of children and young people at school.

Please take the time to read the brochure attached at the end of this newsletter for important information regarding attendance at Maroubra Bay Public School.



The next newsletter will be Thursday 14 February, 2019.

Welcome back everyone.

Matthew Ackerman

Principal



Education  
Public Schools

Follow us on



### Week 1

Tue 29/1	• All Staff return
Wed 30/1	• Students 1-6 return
	• Kinder Best Start
Thu 31/1	• Kinder Best Start
Fri 1/2	• Kinder Best Start
	• PSSA team trials

### Week 2

Mon 4/2	• Kinder start 9am
Wed 6/2	• P&C Meeting 6.30pm
Fri 8/2	• PSSA team trials

### Week 3

Tue 12/2	• 6B Assembly 2.15pm
	• Parent Information Evening
Thu 14/2	• Swimming Carnival
Fri 15/2	• PSSA training

Proudly Supported by



PHILLIPS PANTZER DONNELLEY

## **Resource Fees**

Next week there will be notes going home to students with stationery and other requirements in 2019. The notes are broken into three parts;

1. Resource fees for items such as textbooks, exercise books, online subscriptions and activities such as mindfulness
2. Voluntary school contributions—these are contributions that are not compulsory but assist the school in purchasing equipment. In 2019 we will operate a DGR (Deductible Gift Recipient) where parents can claim their contributions through their tax. More information on how to do that will follow in the next newsletter.
3. Stationery items— a list of items that students in that particular year should bring to school.

An itemized and personal invoice will also be mailed to parents next week with these details as well.

As always, parents are asked to ring or come up and speak to the Principal confidentially if they require assistance for student fees.

## **School Uniform**

Most of our students have come to school with a beautiful school uniform to start the year, and I thank all the students and parents who have helped keep our school looking so fantastic in uniform.

Thank you to the uniform shop volunteers who have done an amazing job of opening the shop at the beginning of the school year to allow parents to purchase new uniforms. We very much appreciate the support of all our wonderful volunteers in this area.

## **Parking**

As we begin another school year, it is timely to remind parents and community members that we have very specific parking zones out the front of our school including a bus bay, no stopping zones and ten minute parking areas.

Please help us look after the safety of all our students and park in the appropriate spaces. Do not block the pedestrian crossing nor park in the bus bay during school pick up times.

Thank you for your support.

## **P&C Meeting**

The first P&C meeting will be held on Wednesday 6 February at 6.30pm in the Library space near the main playground.

We look forward to seeing you there if you can attend.

## **Assembly**

Our first school assembly will be in Week 3 on Tuesday 14 February. Starting at 2.15pm we invite all our community to attend. This first assembly will be hosted by 6B and will acknowledge our award recipients from Presentation Day that were unable to attend.

See you there.

## **Maroubra Bay Breakfast Club**

- *Corn Flakes*
- *Weetbix*
- *Toast with Vegemite or Jam*
- *Apple Juice*
- *Full Cream Milk*



*Breakfast is available from 8am  
at the Canteen, Breakfast is  
served in Plastic Re-Usable Plates,  
Bowls & Cups*

*Please discuss if you require  
Gluten Free options with  
Sallie-Ann*

*Anthony Catering thanks you all  
for your support this year.*



## Contacting the school



Concern/Question/Information	Appropriate Contact
Academic progress of child	Arrange interview with class teacher. Any referrals to the school learning and support team must go through the class teacher.
Welfare of own child	Arrange interview with class teacher.
Health issues - minor	Notify class teacher in writing.
Health issues - more serious	Arrange interview with assistant principal or principal. Develop health care plan with class teacher and principal.
Administering of medication at school	Complete and sign form provided at the office. Medication to be brought to the office in original packaging. Advice from a medical doctor may also be required.
Custody/Court Orders	Arrange interview with principal; provide copies of orders.
Change of address or emergency contact details	Contact office staff and provide proof if required. Notify class teacher.
Explanation of absence	Explanation in writing to class teacher.
Application for exemption (leave longer than 10 school days)	Collect form from office and return to the principal for approval.
Child leaving the school	Notify the class teacher and the school office in writing
Behaviour or actions of a student other than your own child (in class)	Contact your child's class teacher.
Behaviour or actions of a student other than your own child (in the playground)	Contact the Assistant Principal relevant to stage level of your child who will investigate the matter and get back to you within two days.  Kindergarten: Stephanie Aravopoulos  Years 1&2: Brad McGuinness  Years 3&4: Rebecca Hemingway  Years 5&5: Vasilka Jovanovska
School policy or process	Contact office to arrange interview with Principal, providing to office staff an outline of your question or concern.
Please note that you can arrange an appointment by emailing the school at <a href="mailto:maroubraba-p.school@det.nsw.edu.au">maroubraba-p.school@det.nsw.edu.au</a> OR by calling the school office on 9349 1569	



# Maroubra Bay

## Public School

respect | responsibility | care

Parents can stay in touch with what's happening at school in a variety of ways.



### 1. The Maroubra Bay PS app

Search for our school in the app store and stay up to date with alerts, newsletters, policies and other information.

Click on 'More' in the lower right of the app, then 'My Subscription Groups'. Toggle the push categories suitable for you.

## Communication at The Bay



### 2. The school website

<http://www.maroubra-p.schools.nsw.gov.au/>



### 3. Follow us on Instagram

Search for maroubrabay



### 4. Like us on Facebook

Search for Maroubra Bay Public School

### 5. The Office

for paper copies of notes and newsletters

Phone 02 9349 1569

Email

[maroubra-p.school@det.nsw.edu.au](mailto:maroubra-p.school@det.nsw.edu.au)







# 2019

## F Block



Instructional Leader –  
Mrs Hutchison

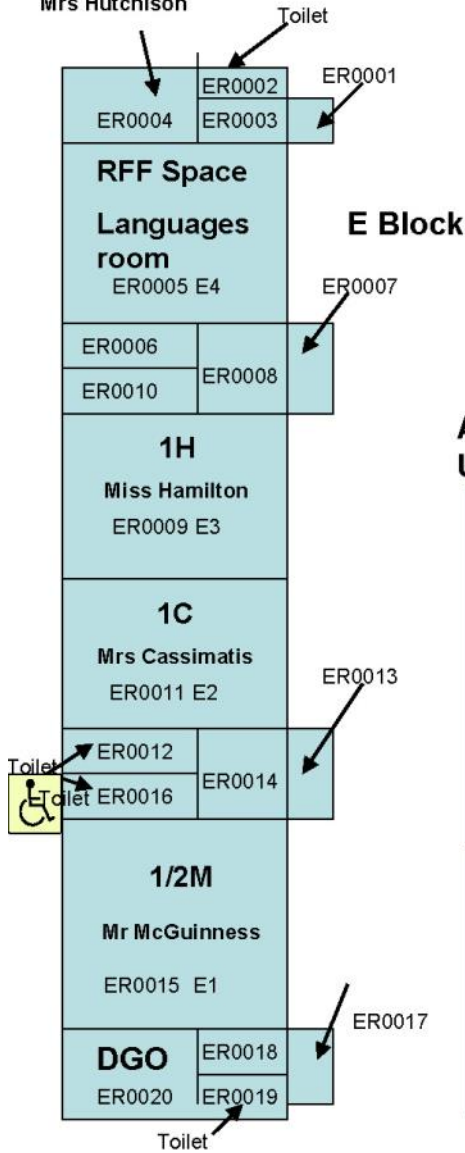

## A Block Upper

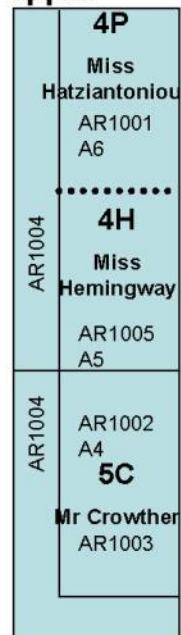

## A Block Lower

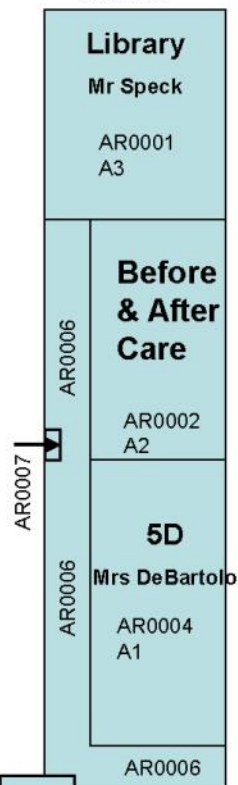

## J Block

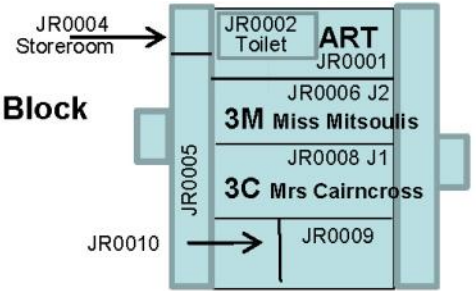

## H Block

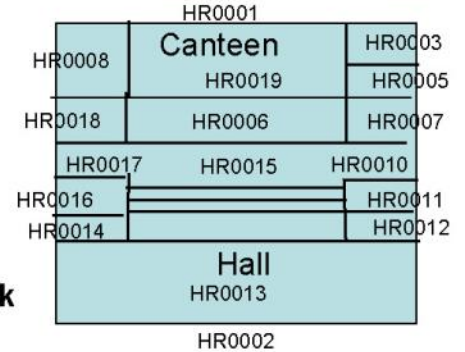

## B Block Lower

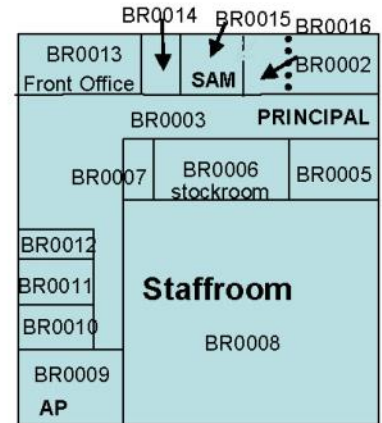

## LaST

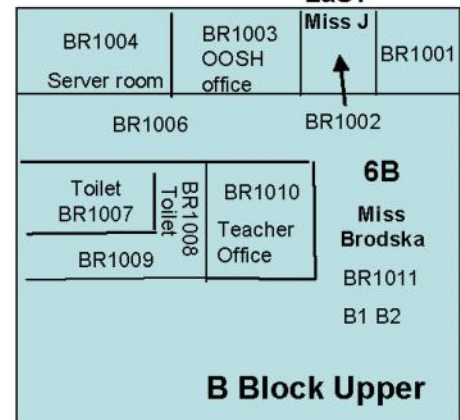

## C Block

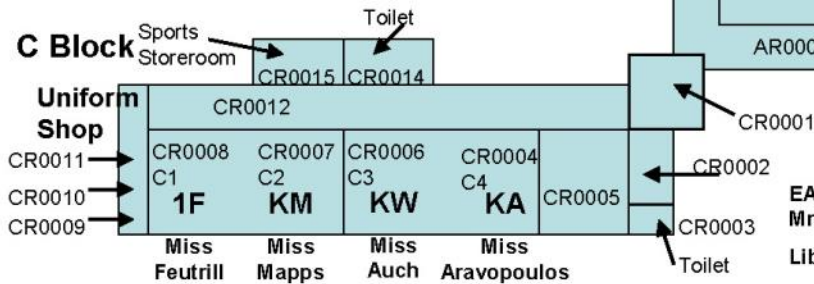

EAL/D Mrs Spicer  
Library Office

## D Block

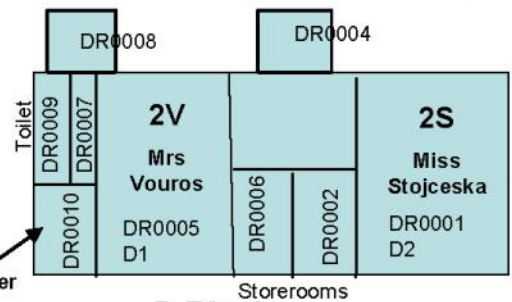



# Maroubra Bay

## Public School Term 1 2019

respect | responsibility | care

Month	Week	Monday	Tuesday	Wednesday	Thursday	Friday
January / February	<b>1</b>	28/1	29/1 Staff Return	30/1 Students 1-6 Return Kinder Best Start	31/2 Kinder Best Start	1/2 Kinder Best Start
February	<b>2</b>	4/2 Kinder students start	5/2	6/2 P&C Meeting February	7/2	8/2
February	<b>3</b>	11/2	12/2 Parent Information Evening	13/2	14/2 Swimming Carnival Yr2-6	15/2
February	<b>4</b>	18/2	19/2	20/2	21/2	22/2 P&C Welcome Night
February / March	<b>5</b>	25/2	26/2	27/2	28/2	1/3
March	<b>6</b>	4/3	5/3	6/3 School Photo Day P&C Meeting March	7/3	8/3
March	<b>7</b>	11/3	12/3	13/3 Backup Photo Day	14/3	15/3 Anti-Bullying Day
March	<b>8</b>	18/3	19/3	20/3	21/3 Harmony Day	22/3
March	<b>9</b>	25/3	26/3	27/3	28/3	29/3
April	<b>10</b>	1/4 Term 2 Planning Week	2/4	3/4	4/4	5/5 Disco
April	<b>11</b>	8/4 P&C Mufri Day	9/4 Anzac Day Assembly	10/4	11/4	12/4 Easter Hat Parade 2pm



# Maroubra Bay School Uniform Order Form – 2018

**Fridays: 8:40am-9:10am**

**Term 4**

[Please fill out ALL the details below]

Student's name: \_\_\_\_\_ Class: \_\_\_\_\_ Date: \_\_\_\_\_

Parent/Carer's name: \_\_\_\_\_ Contact number: \_\_\_\_\_

Item	Size 4,6,8,10,12,14,16	Quantity	Price	CCard <b>+2.5%</b>	Online <b>+5%</b>
Cap with logo (one size fits all)			\$15	\$15.38	\$15.75
Wide-brim hat with logo (53") <b>UNTIL SOLD OUT</b>			<b>\$10</b>	<b>\$10.25</b>	<b>\$10.50</b>
Wide-brim hat with logo (55" and 57")			\$15	\$15.38	\$15.75
Short-sleeve polo shirt with logo			\$20	\$20.50	\$21
Long-sleeve polo shirt with logo			\$25	\$25.63	\$26.25
Cargo pants			\$25	\$25.63	\$26.25
Track pants - straight leg			\$20	\$20.50	\$21
Track pants - cuffed leg			\$20	\$20.50	\$21
Fleecy zip jacket with logo			\$30	\$30.75	\$31.50
Fleecy V-neck jumper with logo <b>UNTIL SOLD OUT</b>			<b>\$20</b>	<b>\$20.50</b>	<b>-</b>
Waterproof fleecy-lined jacket <b>UNTIL SOLD OUT</b>			<b>\$30</b>	<b>\$30.75</b>	<b>-</b>
Skorts			\$20	\$20.50	\$21
Rugby shorts			\$15	\$15.38	\$15.75
Cargo shorts			\$20	\$20.50	\$21
Summer tunic			\$55	\$56.38	\$57.75
Winter tunic (sizes 4 – 8) <b>UNTIL SOLD OUT</b>			<b>\$40</b>	<b>\$41</b>	<b>-</b>
Winter tunic (sizes 10 – 16) <b>UNTIL SOLD OUT</b>			<b>\$40</b>	<b>\$41</b>	<b>-</b>
Winter skirt			\$40	\$41	\$42
School bag with logo			\$55	\$56.38	\$57.75
PSSA sports socks - Junior (12-3), Youth (2-8)			\$15	\$15.38	\$15.75
Second-hand black school shoes			\$10	\$10.25	\$10.50
Second-hand soccer boots			\$10	\$10.25	\$10.50
Second-hand item(s)					

PAID by: Cash    Credit card    Cheque

TOTAL: \_\_\_\_\_

Shop volunteer: \_\_\_\_\_ Receipt number: \_\_\_\_\_

Credit card payments incur a **2.5%** surcharge (only Visa, Mastercard and Amex are accepted).

Orders made and paid via the online system incur a **5%** surcharge – [www.gtschool.com.au/](http://www.gtschool.com.au/)

All cheques are to be made out to Maroubra Bay P&C.

Version 2.0 October 2018





# Compulsory School Attendance

## Information for parents

Education for your child is important and regular attendance at school is essential for your child to achieve their educational best and increase their career and life options. NSW public schools work in partnership with parents to encourage and support regular attendance of children and young people. When your child attends school every day, learning becomes easier and your child will build and maintain friendships with other children.

### What are my legal responsibilities?

Education in New South Wales is compulsory for all children between the ages of six years and below the minimum school leaving age. The *Education Act 1990* requires that parents ensure their children of compulsory school age are enrolled at, and regularly attend school, or, are registered with the Board of Studies, Teaching and Educational Standards for homeschooling.

Once enrolled, children are required to attend school each day it is open for students.

### The importance of arriving on time

Arriving at school and class on time:

- Ensures that students do not miss out on important learning activities scheduled early in the day
- Helps students learn the importance of punctuality and routine
- Give students time to greet their friends before class
- Reduces classroom disruption

Lateness is recorded as a partial absence and must be explained by parents.

### What if my child has to be away from school?

On occasion, your child may need to be absent from school. Justified reasons for student absences may include:

- being sick, or having an infectious disease
- having an unavoidable medical appointment
- being required to attend a recognised religious holiday
- exceptional or urgent family circumstance (e.g. attending a funeral)

Following an absence from school you must ensure that within 7 days you provide your child's school with a verbal or written explanation for the absence. However, if the school has not received an explanation from you within 2 days, the school may contact you to discuss the absence.

Principals may decline to accept an explanation that you have provided if they do not believe the absence is in the best interest of your child. In these circumstances your child's absence would be recorded as unjustified. When this happens the principal will discuss their decision with you and the reasons why.

Principals may request medical certificates or other documentation when frequent or long term absences are explained as being due to illness. Principals may also seek parental permission to speak with medical specialists to obtain information to collaboratively develop a health care plan to support your child. If the request is denied, the principal can record the absences as unjustified.

### Travel

Families are encouraged to travel during school holidays. If travel during school term is necessary, discuss this with your child's school principal. An *Application for Extended Leave* may need to be completed. Absences relating to travel will be marked as leave on the roll and therefore contribute to your child's total absences for the year.

In some circumstances students may be eligible to enrol in distance education for travel periods over 50 school days. This should be discussed with your child's school principal.







### **My child won't go to school. What should I do?**

You should contact the principal as soon as possible to discuss the issue and ask for help. Strategies to help improve attendance may include a referral to the school's learning and support team or linking your child with appropriate support networks. The principal may seek further support from the Home School Liaison Program to develop an Attendance Improvement Plan.

### **What might happen if my child continues to have unacceptable absences?**

It is important to understand that the Department of Education and Communities may be required to take further action where children of compulsory school age have recurring numbers of unexplained or unjustified absences from school.

Some of the following actions may be undertaken:

- Compulsory Schooling Conferences

You may be asked, along with your child, to attend a Compulsory Schooling Conference. The conference will help to identify the supports your child may need to have in place so they attend school regularly. The school, parents and agencies will work together to develop an agreed plan (known as Undertakings) to support your child's attendance at school.

- Application to the Children's Court – Compulsory Schooling Order

If your child's attendance at school remains unsatisfactory the Department

may apply to the Children's Court for a *Compulsory Schooling Order*. The Children's Court magistrate may order a Compulsory Schooling Conference to be convened.

- Prosecution in the Local Court

School and Department staff remain committed to working in partnership with you to address the issues which are preventing your child's full participation at school. In circumstances where a breach of compulsory schooling orders occurs further action may be taken against a parent in the Local Court. The result of court action can be the imposition of a community service order or a fine.

### **What age can my child leave school?**

All New South Wales students must complete Year 10 or its equivalent. After Year 10, and up until they reach 17 years of age, there are a range of flexible options for students to [complete their schooling](#).

### **Working in Partnership**

The Department of Education and Communities recognises that working collaboratively with students and their families is the best way to support the regular attendance of students at school.

We look forward to working in partnership with you to support your child to fulfil their life opportunities.

**If a student misses as little as 8 days in a school term, by the end of primary school they'll have missed over a year of school.**

Further information regarding school attendance can be obtained from the following websites:

### **Policy, information and brochures:**

<http://www.schools.nsw.edu.au/studentsupport/programs/attendance.php>

### **The school leaving age:**

<http://www.schools.nsw.edu.au/leaving-school/index.php>

### **Do you need an interpreter?**

Interpreting services are available on request, including for the hearing impaired. The Telephone Interpreter Service is available 24 hours a day, seven days a week on 131 450. You will not be charged for this service.

For further advice and questions contact your educational services team

T 131 536

Learning and Engagement

Student Engagement & Interagency Partnerships

T 9244 5129

[www.dec.nsw.gov.au](http://www.dec.nsw.gov.au)

© February 2015

NSW Department of Education and Communities



er text

## MAROUBRA SPECIALIST

**CHRISTIAN WEST | 0432 741 888**

### Christian West's Recent Maroubra Market Activity



61-63 Haig Street  
5 bed, 5 bath, 4 car, Pool  
SOLD IN 10 DAYS



3 Beatty Lane  
5 bed, 3 bath, 3 car  
SOLD



64 Nagle Avenue  
2 bed, 1 bath, 2 car  
SOLD IN 10 DAYS



18 Haig Street  
3 bed, 1.5 bath, 3 car  
SOLD



24 Nagle Avenue  
4 bed, 2 bath  
SOLD IN 11 DAYS



81-83 Holmes Street  
4 bed, 2 bath, 2 car  
SOLD IN 16 DAYS

### NOW LISTING!

If you are thinking of selling in the next 24 months, my advice is January/February is the next best selling period.  
With the potential of an election together with a decline in the market, now is the time to make your move!

If you are thinking of selling, or would like to know what your property is worth, please contact me on 0432 741 888.

**PPD**

PHILLIPS PANTZER DONNELLEY

**[ppdre.com.au](http://ppdre.com.au)**

